

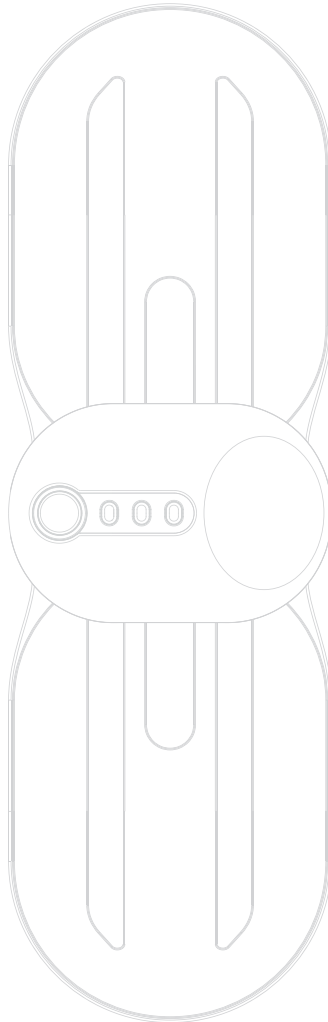

PRIMEKINETIX®
INNOVATIVE MOVES

MYOSTIM2
ELECTRIC MASSAGE + HEAT



Please read this instruction manual carefully, use it safely and correctly,
and store it properly.

CATALOGUE

Product Introduction	-----1
Safety Instructions	-----2
Attachment List	-----3
Functional Areas	-----3
Gluing operation	-----3
Charging Instructions	-----4
Host Operation	-----5
Remote Control Operation	-----5
Usage Instructions	-----6
Maintenance Instructions	-----7
Product Storage	-----7
Troubleshooting	-----8
Material Description	-----9
Product Specifications	-----9

Product Introduction

Welcome to PrimeKinetix, use MYOSTIM2 when your muscles are sore and tired.

MYOSTIM2 Instrument set of 3-stage heating, 3 massage modes, 5 massage techniques in one, the use of EMS from professional athletes muscle relaxation special technology, applicable to the stiffness of the muscles after exercise, soreness, pain and other discomforts. Let you enjoy professional physiotherapy massage anytime and anywhere.

MYOSTIM2 automatically shuts off after each program, with a default duration of 10 minutes. It offers 3 temperature settings and 15 intensity levels that can be adjusted to cater to your health needs.

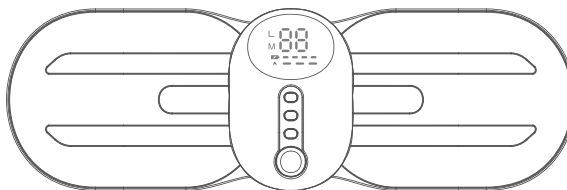
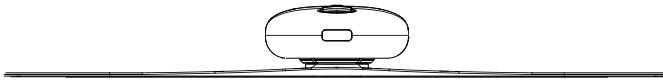

Important Notes

- Please read this instruction manual carefully before using and store it properly for future reference.
- Keep out of the reach of children.
- Before using the EMS function, please attach the product to your skin and then turn it on.
- During use, avoid contact with indirect conductive materials on the body, such as electronic watches, rings, earrings, etc., to prevent damage or static electricity.
- Prolonged use on the same area may cause skin redness; please stop using or switch to a different area.
- When replacing the gel pads, please use the matching products provided by this brand, and it is recommended for the same user to use the same pair of gel pads.
- When disposing of the product and batteries, please categorize and handle them properly.

Compulsory compliance

- It is prohibited to damage the product by pinprick or forceful tearing.
- Prohibited for use in bathrooms and damp environments to prevent malfunction.
- Prohibited to peel off or change the massage patches while the power is on.
- Prohibited for use on the head, around the heart, tattooed areas, and genital regions.
- Prohibited for use while driving, engaging in strenuous physical activity, sleeping, or bathing.
- Children or individuals with language disabilities should not use this product.
- For elderly individuals and those who cannot care for themselves, use of the product should be accompanied by someone.
- Do not store in direct sunlight, areas with excessive dust, or places with significant fluctuations in temperature or humidity.
- Do not disassemble, modify, or attempt to repair this product without proper authorization.
- It is prohibited to use this product simultaneously with other medical devices.

Prohibited and cautioned user groups

- Usage is prohibited when excessively intoxicated.
- After consuming food, please refrain from immediate application to the abdominal area.
- This product is not to be used by individuals with severe arrhythmias, cardiovascular diseases, malignant tumors, epilepsy, sensory impairments, or blood disorders.
- Usage is prohibited on areas with skin inflammation, skin sensitivity, breast inflammation, burns, bleeding, or itching.
- Pregnant women and children under 12 years of age are prohibited from using this product.
- Patients with allergies to the gel patches are prohibited from using this product.
- Individuals with implanted electronic devices within their bodies (such as pacemakers, cardiac defibrillators, and stents) are prohibited from using this product.

- Patients with fever symptoms or undergoing treatment should follow medical advice.
- Individuals with acute inflammation and a tendency to bleed should follow medical advice.
- Patients with severely abnormal blood pressure, severe anemia, and low blood sugar should follow medical advice.

Appendix

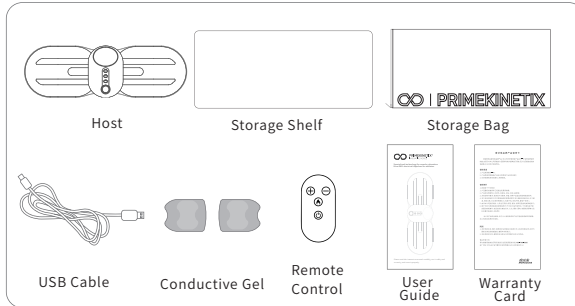

Functional area

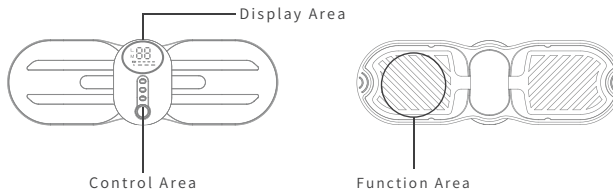

Adhesive operation

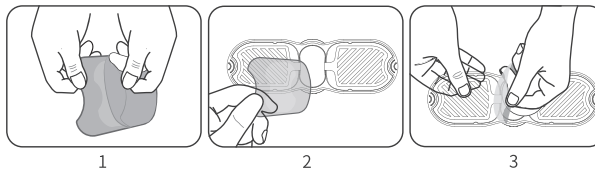

1. Remove the conductive gel by first peeling off the blue plastic film on the surface of the gel.
2. Refer to the diagram and apply the gel to the corresponding conductive pattern area on the back of the product.
3. Then, peel off the transparent film on the surface of the gel to complete the application.

(Note: Please try to avoid applying the gel unevenly, wrinkling, or trapping air bubbles. If any air bubbles are present, use your fingers to push them outwards from under the gel.)

Charging instructions

Before use, charge the device using the supplied USB cable, which can be connected to a computer or adapter, and ensure that each charge lasts a full 2 hours.

Indicator status when charging: when charging, the power indicator flashes; when full, the charging indicator is always on. Standard charging voltage and charging current: 5.0V/1.0A.

When the voltage is low during the use of the product, the power indicator flashes in the last frame and is accompanied by a buzzer alarm.

Do not use an adapter with a charging voltage greater than 5.0V or a charging current greater than 1.0A to charge the device to avoid damaging internal components

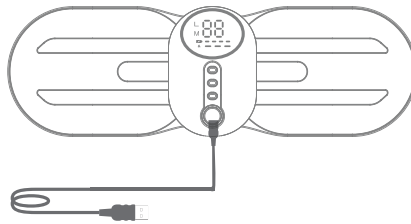

Host Operation

Three Different Modes Can Be Freely Switched

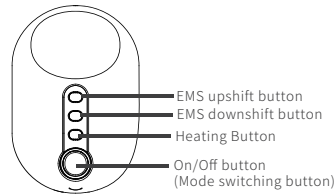

On/Off button (Mode switching button)

1. Long press the on/off button to switch on the main unit, the default mode after switching on is C1 mode, 0 gear strength.
2. In the boot state, short press the switch button to switch mode, the display digital display area shows C1-C3 mode, short press cycle. After switching mode the intensity drops to 0 gear.
3. In the power-on state, long press the on/off button to switch off the main unit.

EMS upshift button/EMS downshift button

1. When the device is turned on, press the EMS Increase Button/EMS Decrease Button briefly to adjust the EMS intensity. The display screen will show the current intensity level in the numeric display area.
2. When the EMS intensity is at level 0, a short press on the EMS Decrease Button will cause the main unit buzzer to produce two 'beep' sounds to indicate it has reached the minimum level. Conversely, when the EMS intensity is at level 15, a short press on the EMS Increase Button will result in the main unit buzzer producing two 'beep' sounds to indicate it has reached the maximum level.

Heating Button

1. Press the Heating Button briefly to activate the heating function. After activating the heating function, press the Heating Button briefly to switch between heating levels. One light indicates the first level, two lights for the second level, and three lights for the third level. Press it briefly to cycle through.
2. After activating the heating function, press and hold the Heating Button to deactivate the heating function.

Remote control operating instructions

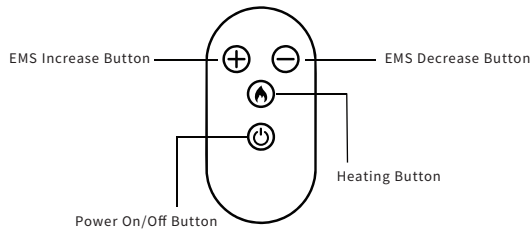

1. When the main unit is switched on, short press the "+" or "-" button on the remote control to adjust the EMS output strength of the main unit.
2. In the state of the host on, short press the "🔥" button on the remote control can open the heating function, short press again to switch gears; long press "🔥" button to close the heating function.
3. When the main unit is powered on, press the "⏻" button on the remote control briefly to switch between massage modes
4. When the main unit is powered on, press and hold the "⏻" button on the remote control to turn off the main unit.

Notes:

1. C1-C3 modes have a runtime of 10 minutes. After 10 minutes, the buzzer will emit one 'beep' sound, and the main unit will shut down.
2. When switching modes, EMS intensity is reset to level 0, and the main unit's runtime is not affected.
3. During usage, if the main unit operates with no load, EMS intensity will decrease to level 0. The main unit will emit three 'beep' sounds as an alarm, and it will automatically shut down after one minute.
4. When the main unit is turned on with the heating function activated and without any load, no alarm will sound. This is the product's preheating feature, which warms up the silicone pads to ensure they are not irritating to the skin when applied.

Usage Method

Before use, please clean and dry the area of the body where the product will be applied. Slowly peel off the protective film from the gel on the product and attach the device to the part of the body to be used (such as shoulders, neck, arms, calves, soles of feet, etc.), and press down on the gel to ensure full contact with the skin. When using the device for the first time, start at a low setting and, once accustomed, gradually increase the intensity

Universal For All Parts Of The Body Where The Soreness Where The Paste

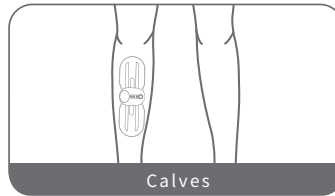
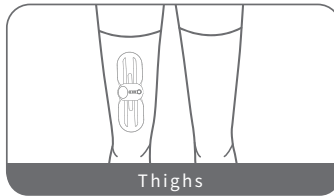
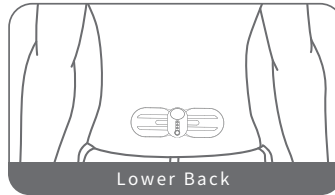
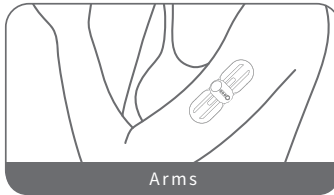
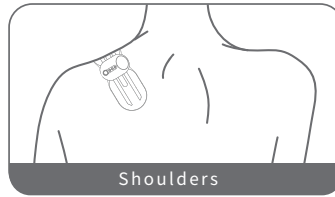
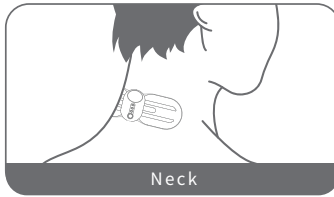

Three Modes Five Massage Techniques

(When your muscles are sore and tired, just use MYOSTIM2)



Beating



Tapping



Kneading



Rubbing



Massage



15 Levels of Intensity



Timer for 10 Minutes

Maintenance instructions

- Please charge before first use to extend battery life; do not use a fast charger adapter. If the device is not going to be used for a long period, please fully charge it before storage and recharge the device at least once every 2-3 months.
- Before use, please wipe the area to be massaged with a damp towel or cloth to clean it, removing any oil and sweat stains before use, to extend the lifespan of the gel pads.
- After use, please gently peel off the gel pads starting from one end of the device to the other in sequence, being careful to avoid sticking the gel pads together, which can extend the life of the gel pads
- Under normal circumstances, the gel pads can be reused approximately 30-50 times. If the stickiness of the gel pads decreases, you can moisten your fingers with water and gently touch the surface of the gel to make it damp. After drying, the stickiness will be partially restored.
- When the gel pads are not sticky enough, first, the desired massage effect will not be achieved, and second, it may cause a stinging sensation. When the stickiness of the gel pads cannot be restored, please replace them with new ones.
- If there are stains on the surface of the device, they can be wiped off with a wet wipe or tissue. If the gel has stains, use your fingers to dab a little water and gently clean the surface of the gel.
- Do not use or store this product in the following environments: places with direct sunlight, strong electromagnetic fields, high temperature and high humidity, areas with excessive dust, or near open flames.

Product Storage

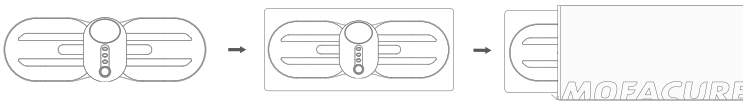

- As shown in the diagram: After removing from the body, please stick it onto the storage board for storage.
- Do not allow the gel pads to come into contact with each other, for instance, by folding the product.

- Do not press too hard on the gel pads while they are on the storage board, as this may damage the surface of the gel.
- Please do not bend the storage board, as this may cause deformation and prevent normal use.

Safety Precautions:

- Keep the storage board clean.
- When storing the product, avoid places with high temperatures or humidity (such as inside a car), and avoid direct sunlight.
- When not in use, please store in a safe place, away from children and pets.

Troubleshooting

Unable to power on.	When the battery is low, please charge the product.
Abnormal shutdown.	If the device is not fully adhered to the skin, please ensure that the device is completely attached to the skin or dampen the area with a wet towel before turning on and using the device.
Massage intensity is weak.	<ol style="list-style-type: none"> 1. If the setting is too low, please press the '+' button to adjust. 2. If the gel pad's stickiness is poor, please replace the gel pad.
Device cannot be charged	Please ensure that the power adapter being used has an output voltage of DC 5V/1A and is in normal working condition.
Feeling of being pricked by needles during use.	<ol style="list-style-type: none"> 1. Ensure that the gel pads are smoothly and evenly adhered to the skin. If the gel pads are not sticky enough, clean and moisten them with water to restore their stickiness before use, or replace them with new ones. 2. If you experience a stinging sensation at any location during each use, you may have a sensitive constitution and this product may not be suitable for you.

Material Description

	shell	circuit board	battery pack	electrode sheet	charging cable	wrap
Lead(Pb)	○	○	○	○	○	○
mercury(Hg)	○	○	○	○	○	○
Cadmium(Cd)	○	○	○	○	○	○
Hexavalent chromium(Cr, VI)	○	○	○	○	○	○
polybrominated biphenyls(PBBs)	○	○	○	○	○	○
Polybrominated Diphenyl Ethers(PBDEs)	○	○	○	○	○	○

O: Indicates that the content of the toxic or hazardous substance in all homogeneous materials of the component is below the limit requirements as specified in GB/T 26572-2011

X: Indicates that the content of the toxic or hazardous substance exceeds the limit requirements as specified in GB/T 26572-2011 in at least one homogeneous material of the component

All components marked with "X" in the table comply with the EU RoHS Recast Directive 2011/65/EU

Product Specifications

Product Name	MYOSTIM2
Product Material	Silicone, Polycarbonate + Acrylonitrile Butadiene Styrene(PC+ABS)
Product Model	MFJ-9117LH
Product Dimensions	205X65X23mm
Product Weight	65g
Pulse Width	150us
Output Power	<5 watts (W)
Product Frequency	2.5-100Hz
Operating Temperature	0°C-45°C
Operating Humidity	Relative Humidity ≤85%
Product Power Source	Rechargeable Lithium Polymer Battery
Battery Capacity	900m/Ah



PRIMEKINETIX®
INNOVATIVE MOVES

MYOSTIM2
ELECTRIC MASSAGE + HEAT

Brand Owner: Ningbo ileenoe Healthy Technology Co., Ltd.

Address: No. 226, Xianghe West Road, Yinzhou District, Ningbo, Zhejiang Province

Manufacturer: Ningbo Inno Healthcare Technology Co.,Ltd.

Manufacturing Address: No. 226, Xianghe West Road, Yinzhou District, Ningbo, Zhejiang Province

Standards Implemented: GB4706.10-2008/GB4706.1-2005; Service Hotline: 400-700-5886